

| REVISIONS |      |  |                  |          |     |        |
|-----------|------|--|------------------|----------|-----|--------|
| ZONE      | LTR. | DESCRIPTION  | ECN NO.          | DATE     | BY  | APPR'D |
|           | A    | RELEASED FOR PRODUCTION                                | DR7633           | 10/15/06 | DPZ |        |
|           | B    | B1 WAS WIRE TIE  | CR71215          | 8/21/07  | DJC | DJC    |
| 2B        | C    | C1 REMOVED WIRE SLEEVE                                 | DR16326<br>71450 | 19MAY08  | SLK | DJC    |
| 3A        | D    | D1 UPDATE ASSEMBLY TO PUMP CAP/DOME COVER PLATE DESIGN | DR23287          |          |     |        |
| 4C        |      | D2 ADD WIRE HARNESS DETAIL                             | 71893            | 28APR09  | WDE | DJC    |
|           |      | D3 RV0000316 WAS RV0000318                             | 72049            |          |     |        |
|           |      | D4 TU208 WAS FM0001631 ON CHART DRAWING SA0039239      |                  |          |     |        |
| 3A        | E    | E1 REPLACED "HOT STAMP INFO" WITH "MARKING INFO"       | 73288            | 02DEC10  | SLK | DJC    |

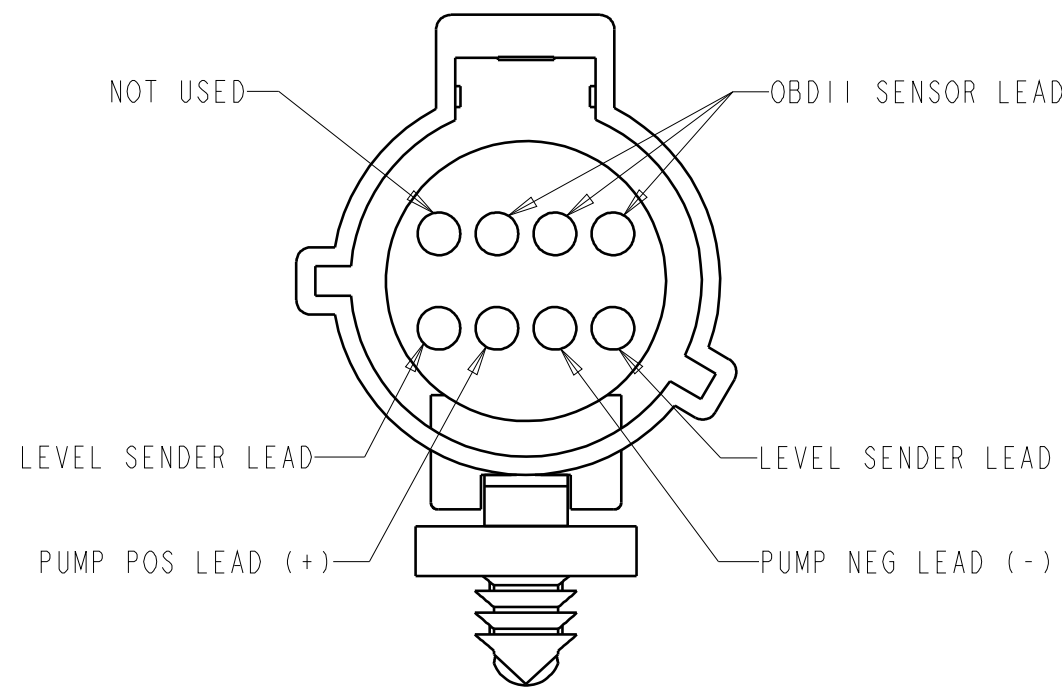

CONNECTOR  
MODULE MAIN  
PINOUT DETAIL  
SCALE 2:1

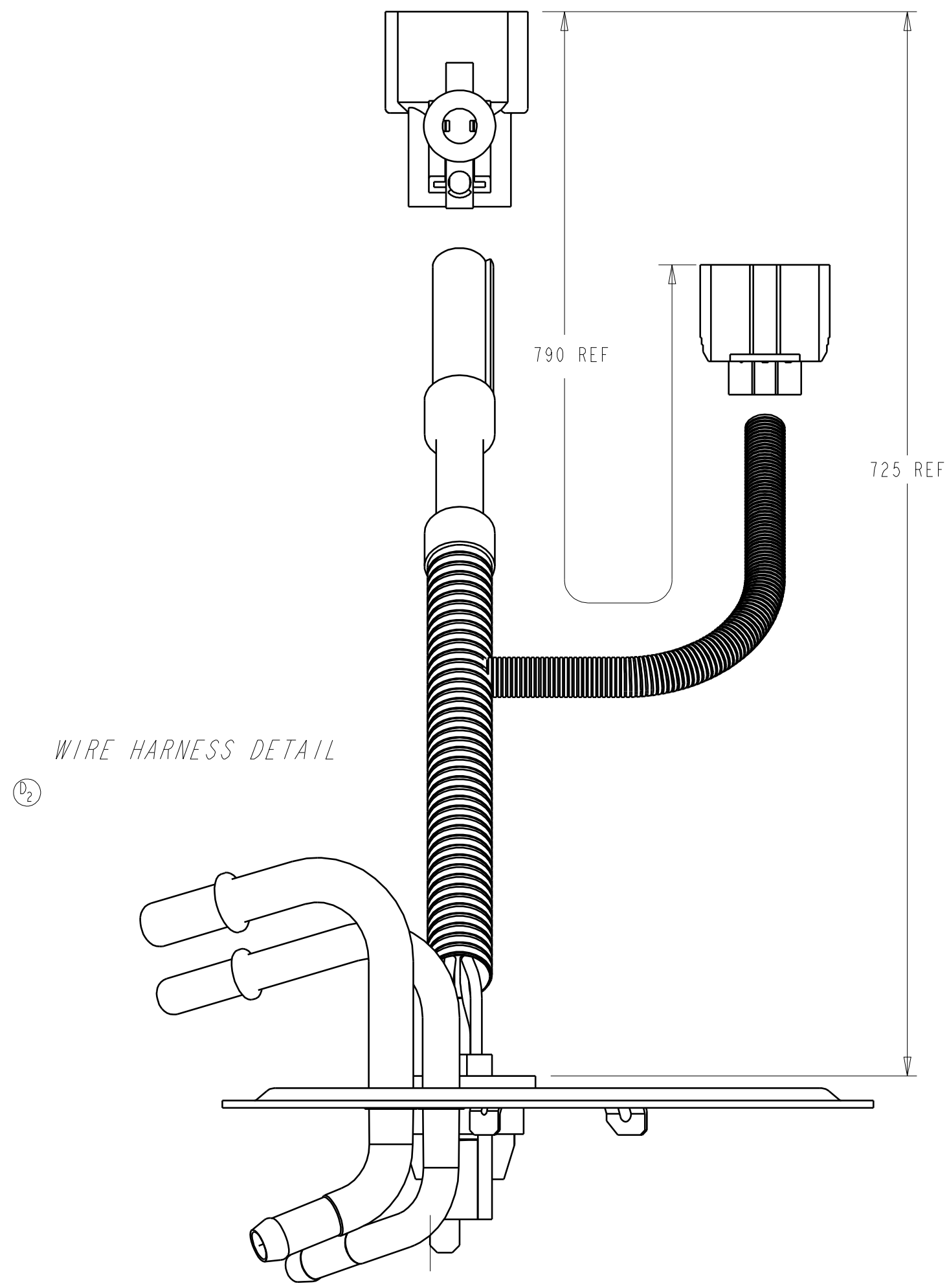

MAIN CONNECTOR PLUG

OBDII SENSOR PLUG

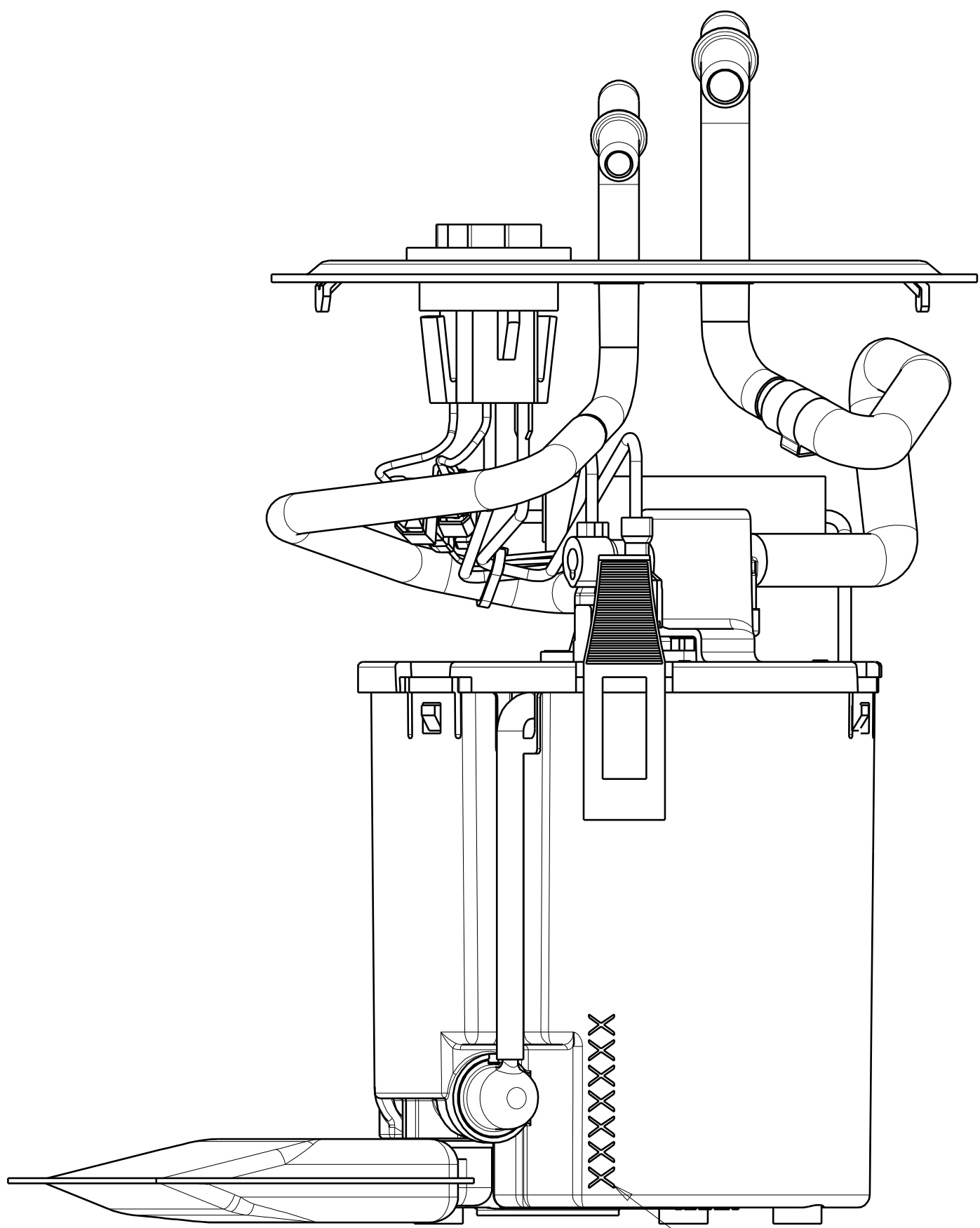
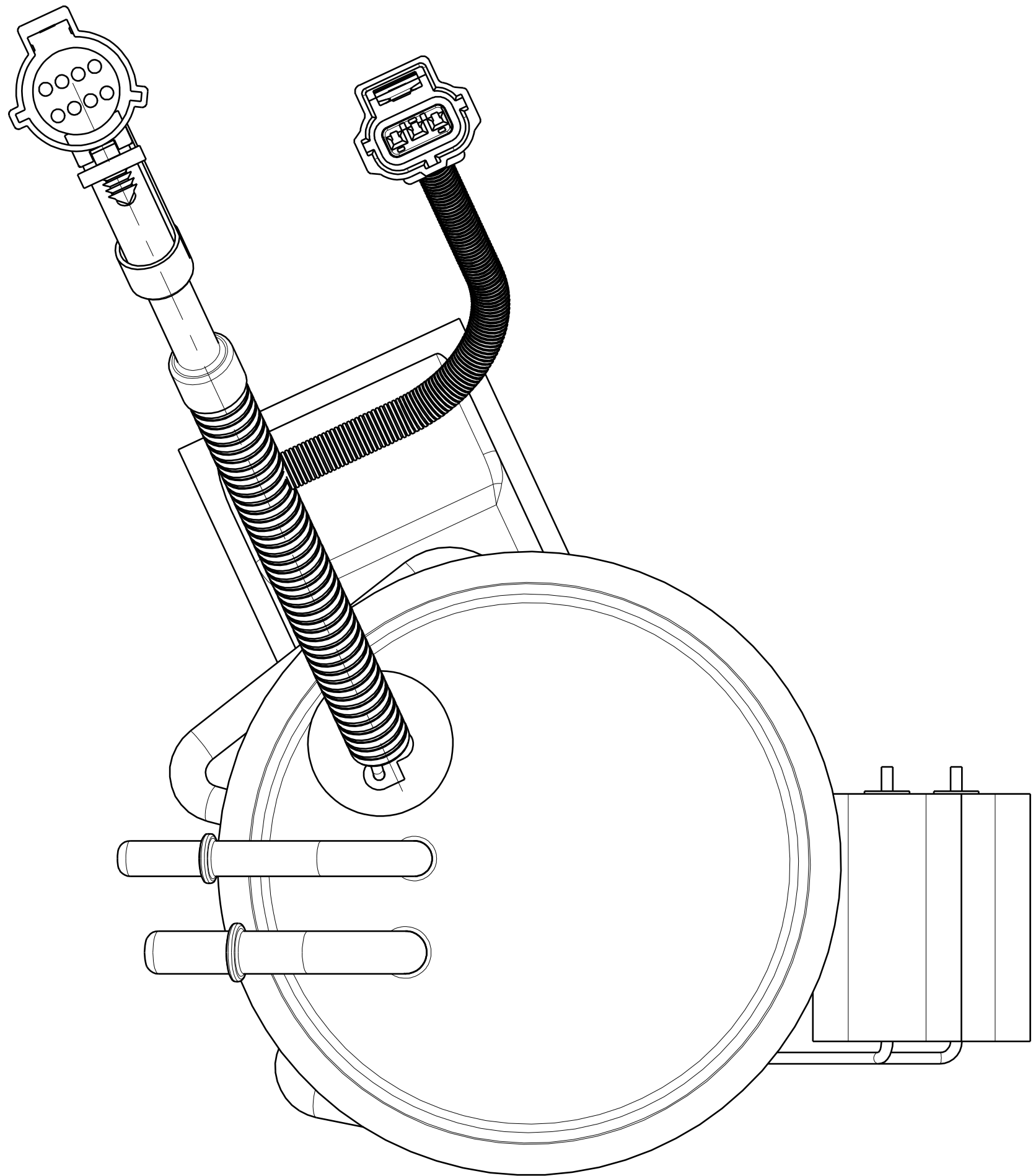

MARKING INFO  
REFERENCE BILL OF MATERIALS

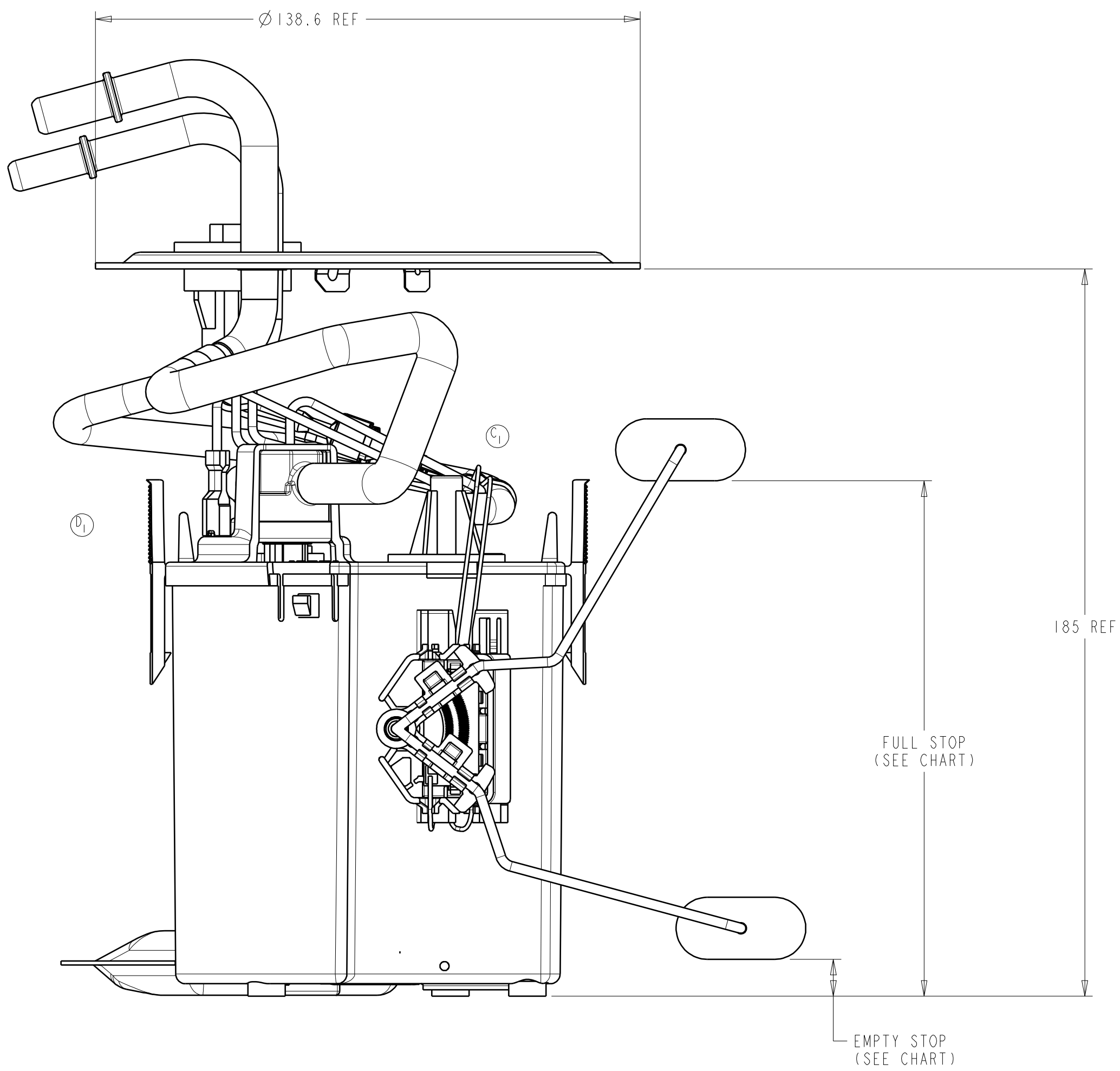

| FLOAT<br>POSITION  | RESISTANCE<br>(OHMS) |
|--------------------|----------------------|
| FULL STOP (131.7)  | 160.5±3.0            |
| EMPTY STOP (110.0) | 15±1                 |

- NOTE:
- SPECIAL CUSTOMER PACKAGING REQUIREMENTS MAY CALL FOR THE ADDITION OF SPECIFIC LABELS NOT SHOWN ON THIS DRAWING.
  - SHOWN WIRE ROUTING MAY DIFFER FROM FINISHED PRODUCT.
  - SHOWN RESISTOR CARD AND PUMP TERMINATION MAY DIFFER FROM FINISHED PRODUCT.

|  |  |  |                      |   |               |
|--|--|--|----------------------|---|---------------|
| INTERNAL USE ONLY<br>DISTRIBUTION CODE |  | <b>TI Automotive</b>                       |                      | AFTERMARKET DIVISION<br>630 COLUMBIA STREET<br>CARO, MICHIGAN 48723 |               |
| REF: FM0001631                         | DO NOT SCALE PRINT                                       | TOLERANCE<br>UNLESS OTHERWISE<br>SPECIFIED | MATERIAL             | SCALE: 1:1  | DATE: 3/20/06 |
| DO NOT SCALE PRINT                     | DIMENSIONS AND TOLERANCES<br>PER ANSI/ASME Y14.5M - 1994 | SIZE<br>E                                  | FINISH               | DRN: BY: D. P. ZBORAY   | CHK'D BY:     |
| PRODUCTION                             | PRODUCTION   | PRODUCTION                                 | PRODUCTION           | APPR'D BY:  |               |
| TITLE<br>FUEL MODULE OUTLINE           |  |  | DRAWING NO.<br>TU208 |   | REV.<br>E     |